

CORNER RECORD

Agency Index

BOOK 132 PAGE 67

Document Number

CR 13813

City of OAKLANDCounty of ALAMEDA, California

Brief Legal Description

CITY MONUMENT 11NW9R AS SHOWN UPON MONUMENT MAP 1512B486_276 AND FORESTLAND MANOR
FILED FOR RECORD JANUARY 28, 1928 IN BOOK 18 OF MAPS AT PAGE 54, A.C.R.**CORNER TYPE****COORDINATES (Optional)**RANCHO
SAN
ANTONIO
(A.M. PERALTA)Government Corner ☐ Control
Meander ☐ Property
Rancho ☐ Other

N. _____ E. _____

☒ Elevation _____Units Metric ☐ U.S. Survey Foot ☒☐ Horizontal Datum _____

Zone _____ Epoch Date _____

Vertical Datum _____

Date of Survey 11/12/2019☐ Complies with Public Resources Code §§8801-8819☐ Complies with Public Resources Code §§8890-8902

PLS Act Ref:

☐ 8765(d)☒ 8771☐ 8773☐ Other:Corner/
Monument:☒ Left as found☐ Established☐ Rebuilt☒ Pre-Construction☐ Found and tagged☐ Reestablished☒ Referenced☐ Post-Construction

Narrative of corner identified and monument as found, set, reset, replaced, or removed:

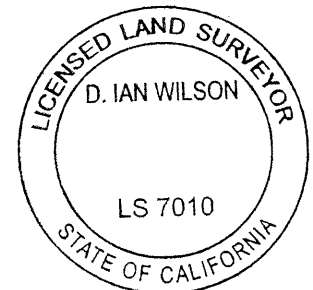
☒ See sheet #2 for description(s):FOUND MONUMENT THAT COULD BE DAMAGED OR DESTROYED BY A PROPOSED ELECTRIC UNDERGROUND CONSTRUCTION PROJECT.
MONUMENT WAS REFERENCED AS SHOWN ON PAGE 2 OF 2.THE PURPOSE OF THIS CORNER RECORD IS TO PRESERVE THE LOCATION OF THE MONUMENT PRIOR TO CONSTRUCTION. NO
ATTEMPT WAS MADE TO DETERMINE THE RELATIONSHIP BETWEEN THE MONUMENT AND BOUNDARY LINES OR OTHER MONUMENTS.**SURVEYOR'S STATEMENT**This Corner Record was prepared by me or under my direction in conformance with
the Professional Land Surveyors' Act on APRIL 10, 2020Signed Erik Paul Kiel P.L.S. or R.C.E. No. 8911**COUNTY SURVEYOR'S STATEMENT**This Corner Record was received APR 15 2020and examined and filed APR 15 2020Signed D. Ian Wilson P.L.S. or R.C.E. No. 7010Title ALAMEDA COUNTY SURVEYOR

County Surveyor's Comment _____

CC-19/03_009
MARK THOMAS



SCALE: 1" = 30'

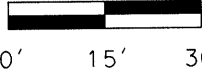

8945 SKYLINE BLVD
APN 48D-7297-56-2

8899 SKYLINE BLVD
APN 48D-7297-55

CITY
APN 48D-7297-56-3

CITY MONUMENT
11NW8R [EX84G1]
NOT FOUND

CITY
MONUMENT
11NW9R
[DW73F7]

PATH

SKYLINE BOULEVARD
(WIDTH VARIES)

(N 87°10' E 111.18') (18-MAPS-54)

N 81°47'27" E 91.86'

S 82°22'53" W
47.21' [47.22']

N 60°17'05" W
26.64'

N 35°34'50" E
44.29' [44.29']

2838 BURTON DRIVE
APN 48D-7296-33

2842 BURTON DRIVE
APN 48D-7296-32

FORESTLAND
MANOR
18-MAPS-54

BASIS OF BEARING:

BEARING BASIS IS ASSUMED

LEGEND:

- FOUND CONCRETE MONUMENT WITH 1/4" PIN IN WELL
- ⊙ FOUND MAG NAIL IN A.C.
- FOUND MAG NAIL IN TREE LIMB
- ⊙ SET MAG NAIL IN A.C. (COUNTERSUNK)

[] RECORD INFORMATION FROM CR 5101 (BK 47 PG 33) A.C.R.

[DW73F7] ALAMEDA COUNTY MONUMENT IDENTIFICATION NUMBER