

**OWNER'S STATEMENT**

THE UNDERSIGNED HEREBY STATES THAT SHE IS THE OWNER OF THE LAND DELINEATED AND EMBRACED WITHIN THE EXTERIOR BOUNDARY LINES ON THE HEREIN EMBODIED PARCEL MAP ENTITLED "PARCEL MAP 9635, CITY OF OAKLAND, COUNTY OF ALAMEDA, STATE OF CALIFORNIA;" THAT SAID OWNER ACQUIRED TITLE TO SAID LAND BY VIRTUE OF THE GRANT DEED RECORDED NOVEMBER 4, 2003 UNDER SERIES NO. 2003-656467 IN THE OFFICIAL RECORDS OF ALAMEDA COUNTY, STATE OF CALIFORNIA: THAT SHE CONSENTS TO THE PREPARATION AND FILING OF THIS PARCEL MAP.

THE AREA MARKED "NON-EXCLUSIVE INGRESS/EGRESS AND UTILITY EASEMENT" AS SHOWN ON SHEET 2 IS FOR THE BENEFIT OF PARCEL 2, THEIR HEIRS, SUCCESSORS, ASSIGNS AND OTHERS AS REQUIRED BY LAW.

IN WITNESS WHEREOF WE HAVE CAUSED THESE PRESENTS TO BE EXECUTED THIS 30<sup>th</sup> DAY OF JUNE, 2014

OWNER(S):

BY: [Signature] ARIANA MOHIT

**OWNER'S ACKNOWLEDGEMENT**

STATE OF CALIFORNIA }  
COUNTY OF Alameda } SS.

ON June 30, 2014, BEFORE ME,  
E. Cotter

A NOTARY PUBLIC, PERSONALLY APPEARED ARIANA MOHIT WHO PROVED TO ME ON THE BASIS OF SATISFACTORY EVIDENCE TO BE THE PERSON WHOSE NAME IS SUBSCRIBED TO THE WITHIN INSTRUMENT AND ACKNOWLEDGED TO ME THAT SHE EXECUTED THE SAME IN HER AUTHORIZED CAPACITY, AND THAT BY HER SIGNATURE ON THE INSTRUMENT THE PERSON, OR THE ENTITY UPON BEHALF OF WHICH THE PERSON ACTED, EXECUTED THE INSTRUMENT.

I CERTIFY UNDER PENALTY OF PERJURY UNDER THE LAWS OF THE STATE OF CALIFORNIA THAT THE FOREGOING PARAGRAPH IS TRUE AND CORRECT.

WITNESS MY HAND, AND OFFICIAL SEAL.

SIGNATURE: [Signature]

NOTARY PUBLIC, STATE OF CA COMMISSION NO.: 1993808  
MY COMMISSION EXPIRES: Nov. 9, 2016  
COUNTY OF PRINCIPAL PLACE OF BUSINESS: Alameda

**NOTE:**

THE EXISTING STRUCTURE(S) MAY NOT BE IN COMPLIANCE WITH THE CURRENT CALIFORNIA BUILDING CODE. ANY FUTURE MODIFICATIONS TO WALLS, EAVE OVERHANGS AND ANY ALTERATION OR ADDITION OF OPENINGS ON SAID WALLS MAY NOT BE ALLOWED.

**OWNER'S NAME:** ARIANA MOHIT

**ADDRESS:** 4617 VIRGINIA AVENUE  
OAKLAND, CA 94619

**CITY SURVEYOR'S STATEMENT**

I, GILBERT E. HAYES, CITY SURVEYOR, HAVING BEEN AUTHORIZED TO PERFORM THE FUNCTIONS OF THE CITY SURVEYOR OF THE CITY OF OAKLAND, COUNTY OF ALAMEDA, STATE OF CALIFORNIA, DO HEREBY CERTIFY THAT I HAVE EXAMINED THE HEREIN EMBODIED PARCEL MAP ENTITLED "PARCEL MAP 9635".  
I AM SATISFIED THAT THE PARCEL MAP IS TECHNICALLY CORRECT.

IN WITNESS WHEREOF, I HAVE HEREUNTO SET MY HAND THIS FIRST DAY OF July, 2014.

BY: [Signature]  
GILBERT E. HAYES, P.L.S. NO. 4700  
CITY SURVEYOR  
CITY OF OAKLAND, ALAMEDA COUNTY  
STATE OF CALIFORNIA  
LICENSE EXPIRES 9/30/2015

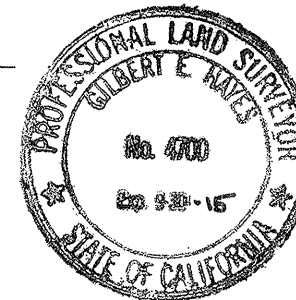

**SURVEYOR'S STATEMENT**

THIS PARCEL MAP WAS PREPARED BY ME OR UNDER MY DIRECTION AND IS BASED UPON A FIELD SURVEY IN CONFORMANCE WITH THE REQUIREMENTS OF THE SUBDIVISION MAP ACT AND LOCAL ORDINANCE AT THE REQUEST OF ZED BATES IN MARCH OF 2011. I HEREBY STATE THAT THIS PARCEL MAP SUBSTANTIALLY CONFORMS TO THE APPROVED OR CONDITIONALLY APPROVED TENTATIVE MAP, IF ANY. I FURTHER STATE THAT ALL MONUMENTS ARE OF THE CHARACTER AND OCCUPY THE POSITIONS INDICATED, AND THAT THE MONUMENTS ARE SUFFICIENT TO ENABLE THE SURVEY TO BE RETRACED.

BY: [Signature]  
DUSTIN B. WILTON  
LICENSE EXPIRES DECEMBER 31, 2015  
LICENSE NO. 8080

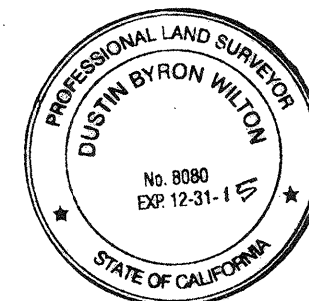

DATE: 6/27/2014

**RECORDER'S STATEMENT**

FILED THIS 12<sup>TH</sup> DAY OF AUGUST, 2014,  
AT 11:02 A.M., IN BOOK 326 OF RECORDS  
OF SURVEY MAPS, AT PAGE 44-45, AT THE REQUEST OF  
OLD REPUBLIC TITLE COMPANY. SERIES NO. 2014198575  
FEE: \$ 11.00

PATRICK O'CONNELL - COUNTY RECORDER

[Signature]  
BY DEPUTY COUNTY RECORDER



**CLERK OF THE BOARD OF SUPERVISORS STATEMENT:**

I, CHERYL PERKINS, ASSISTANT CLERK OF THE BOARD OF SUPERVISORS OF THE COUNTY OF ALAMEDA, STATE OF CALIFORNIA, DO HEREBY STATE THAT CERTIFICATES HAVE BEEN FILED AND DESPOSITS HAVE BEEN MADE IN CONFORMANCE WITH THE REQUIREMENTS OF SECTION 66492 AND 66493 OF THE GOVERNMENT CODE OF THE STATE OF CALIFORNIA.

DATED: 8/1/14

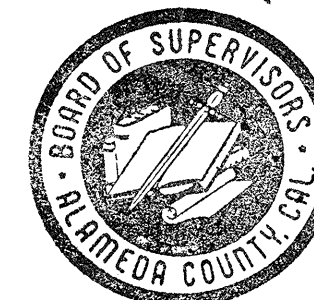

ANIKA CAMPBELL-BELTO, ASSISTANT CLERK OF THE BOARD OF SUPERVISORS, COUNTY OF ALAMEDA, STATE OF CALIFORNIA

BY: [Signature] \$8,358.00

**CITY ENGINEER'S STATEMENT:**

I, MICHAEL J. NEARY, HAVING BEEN AUTHORIZED TO PERFORM THE FUNCTIONS OF THE CITY ENGINEER OF THE CITY OF OAKLAND, COUNTY OF ALAMEDA, STATE OF CALIFORNIA DO HEREBY CERTIFY THAT:  
- I HAVE EXAMINED THE HEREON EMBODIED PARCEL MAP ENTITLED "PARCEL MAP 9635, CITY OF OAKLAND, COUNTY OF ALAMEDA, STATE OF CALIFORNIA;  
- THE SUBDIVISION AS SHOWN UPON SAID PARCEL MAP IS SUBSTANTIALLY THE SAME AS THAT APPEARING ON THE TENTATIVE PARCEL MAP AND ANY APPROVED ALTERATIONS THEREOF;  
- SAID PARCEL MAP COMPLIES WITH ALL PROVISIONS OF THE SUBDIVISION MAP ACT OF THE GOVERNMENT CODE AND THE LOCAL ORDINANCES APPLICABLE AT THE TIME OF THE TENTATIVE PARCEL MAP IN WITNES WHEREOF, I HAVE HEREUNTO SET MY HAND THIS 24<sup>th</sup> DAY OF July, 2014

[Signature]  
MICHAEL J. NEARY, RCE No. 38547  
CITY ENGINEER  
CITY OF OAKLAND, ALAMEDA COUNTY  
STATE OF CALIFORNIA  
LICENSE EXPIRES 3/31/2015

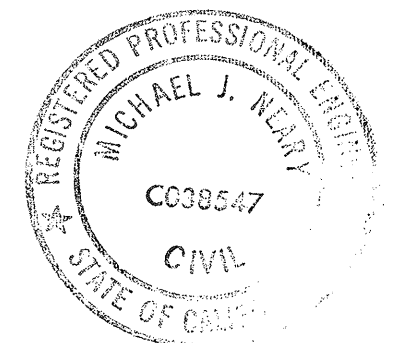

**PARCEL MAP 9635**

VESTED AS OF ORIGINAL SUBMITTAL DATE OF 4/25/11  
BEING A SUBDIVISION OF THAT REAL PROPERTY  
AS DESCRIBED IN THAT CERTAIN DEED DOCUMENT  
NO. 2003656467, RECORDED ON NOVEMBER 4, 2003,  
BEING A PORTION OF LOT 8, MAP ENTITLED "MAP OF THE  
LAND OF THE BROOKLYN LAND COMPANY, SUBDIVIDED  
MARCH 1875" FILED MAY 22, 1878, IN BOOK 5 OF MAPS,  
PAGE 20, COUNTY OF ALAMEDA OFFICIAL RECORDS

CITY OF OAKLAND, ALAMEDA COUNTY, CALIFORNIA  
SHEET 1 OF 2 JUNE 2014

AMERICAN LAND SURVEYING, INC.  
1390 MARKET ST., #112, SAN FRANCISCO, CA 94102  
PH: (415) 888-8580 ALS11020 FAX: (860) 260-5454

APN: 036-2442-033,2

1423 VIRGINIA AVENUE

PARCEL MAP 9635 MAP BR 326 PP 44