

ELEVATION LEGEND	
XXX	EQUIPMENT NUMBER
M2	INDICATES NOTE ON SHEET E2
J	JUNCTION BOX
S	SIMPLEX RECEPTACLE
D	DUPLEX RECEPTACLE
SW	SWITCH
P	PHONE
SK	TERMINATION OF PVC CONDUIT FOR RADIANT POS SYSTEM
DD	DOUBLE DUPLEX RECEPTACLE
SD	SMOKE DETECTOR LED (2 GANG BOX)
SK	SECURITY KEYPAD

**1 OFFICE**  
1/2"=1'-0"

**2 OFFICE**  
1/2"=1'-0"

**3 OFFICE**  
1/2"=1'-0"

**4 OFFICE**  
1/2"=1'-0"

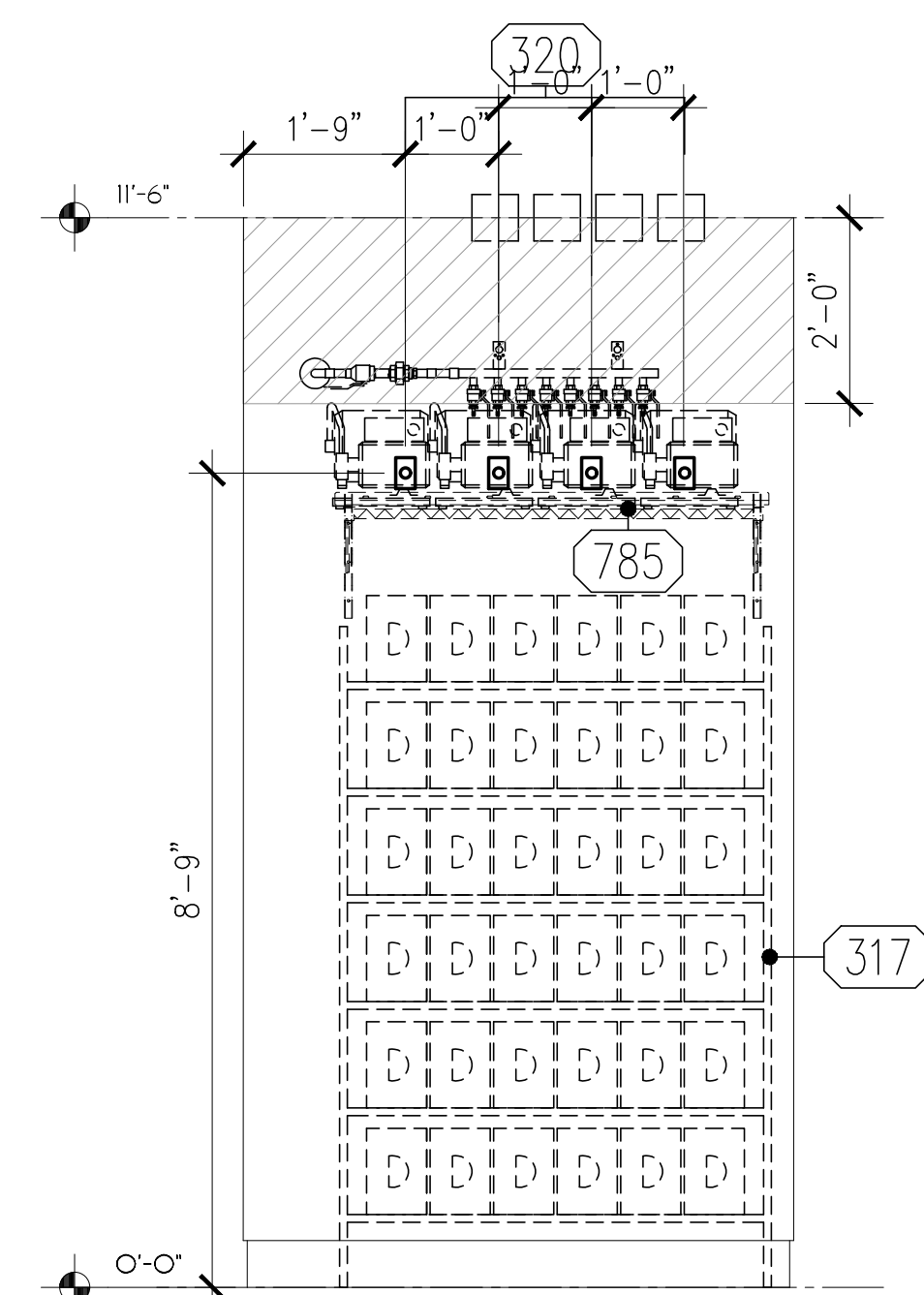

**5 MULTI-PURPOSE**  
1/2"= 1'-0"

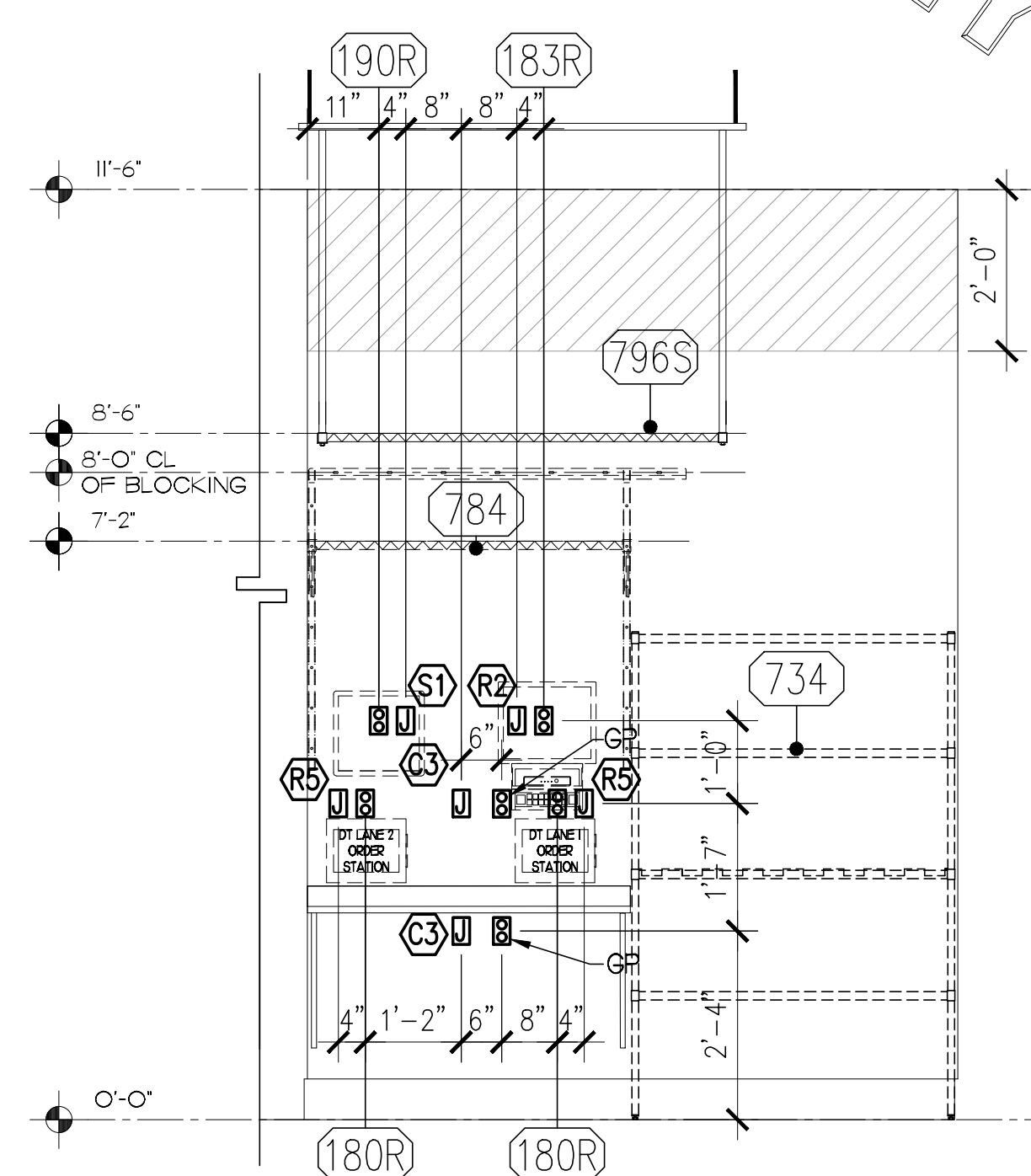

**6 MULTI-PURPOSE**  
1/2"= 1'-0"

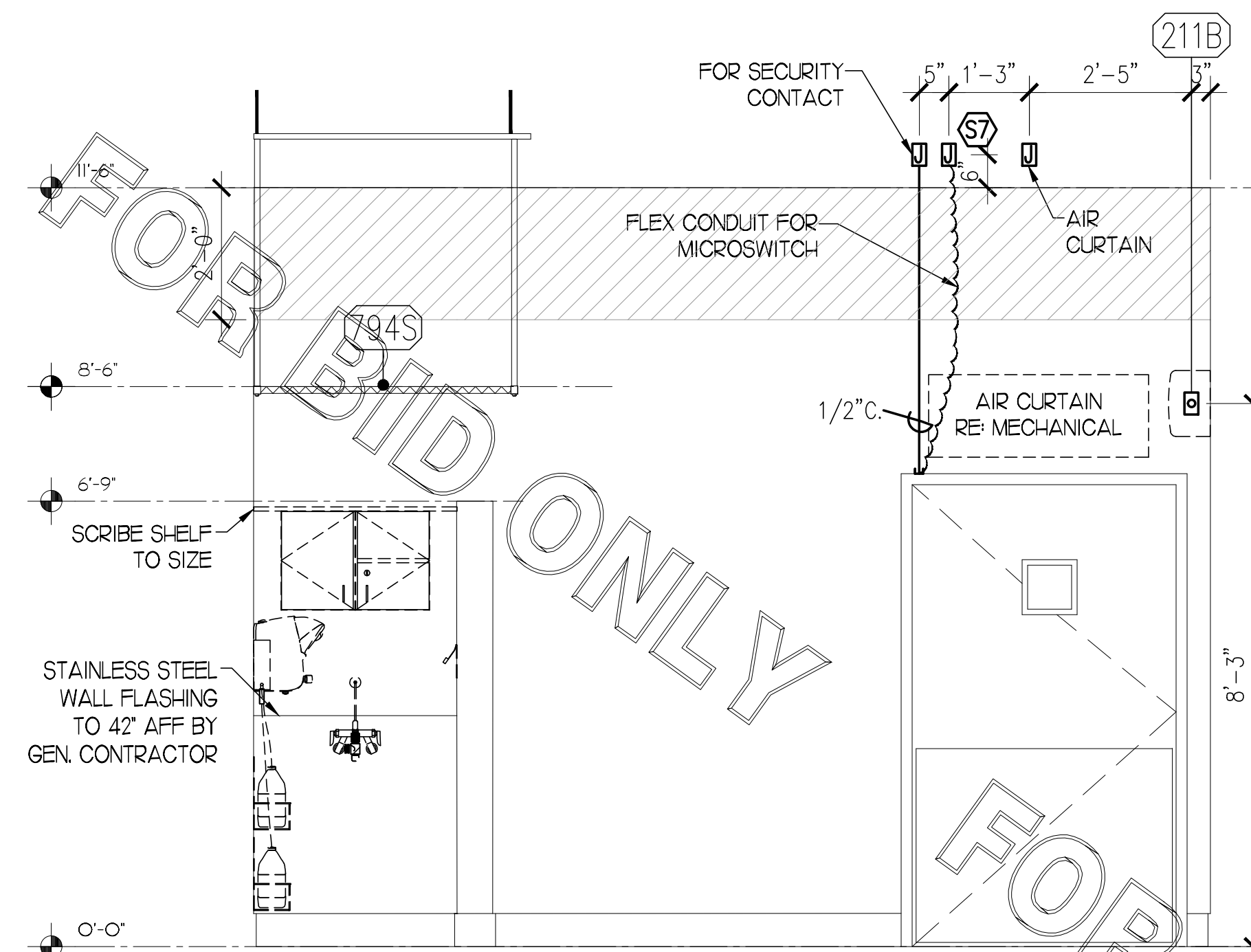

**7 MULTI-PURPOSE**  
1/2"= 1'-0"

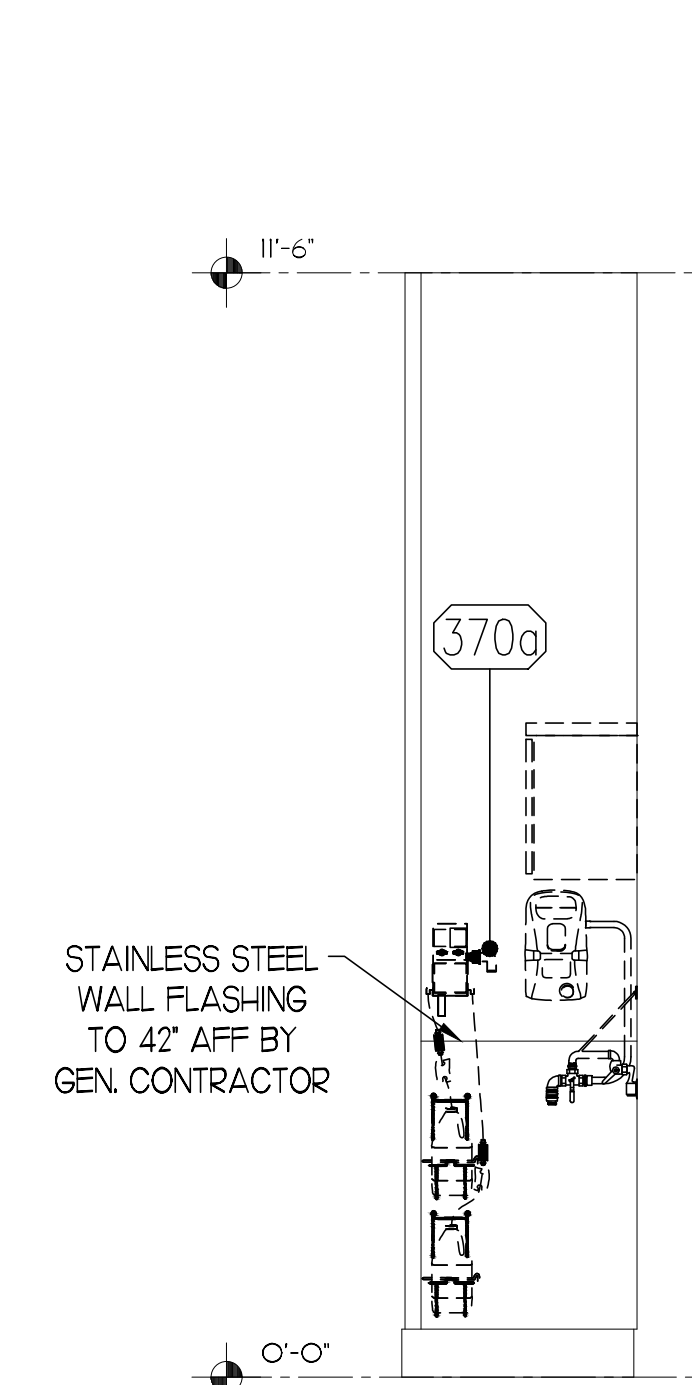

**8 MULTI-PURPOSE**  
1/2"= 1'-0"

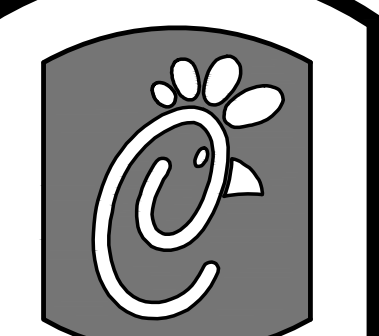

**Chick-fil-A**

5200 Buffington Rd.  
Atlanta Georgia,  
30349-2998

Revisions:

Mark Date By

△

Mark Date By

△

Mark Date By

△

Seal

**TriMark**  
Foodservice Equipment, Supplies and Design  
STRATEGIC

3011 Industrial Parkway East  
Knoxville, Tennessee 37921  
Phone (865) 637-2525  
Fax (865) 522-4448

STORE# 00745

5455 Jimmy  
Carter Blvd.  
Norcross, GA  
30093-1512

SHEET TITLE  
ELECTRICAL  
ROUGH-IN  
ELEVATIONS

DWG EDITION S97-100  
REVISION 00

Job No. :

Store : #00745

Date : 01-19-18

Drawn By : CdL

Checked By: THW

Sheet

**K3.4**