

OWNER'S CERTIFICATE

WE, THE UNDERSIGNED OWNERS AND/OR TRUSTEES, HEREBY CERTIFY THAT WE ARE THE OWNERS OF, OR HAVE SOME RIGHT, TITLE OR INTEREST OF RECORD IN THE LAND SHOWN ON THIS PARCEL MAP, AND WE CONSENT TO THE MAKING AND FILING OF THIS MAP IN THE OFFICE OF THE COUNTY RECORDER.

CENTRAL VALLEY PRODUCTION CREDIT ASSOCIATION, A CORPORATION (FORMERLY MODESTO PRODUCTION CREDIT ASSOCIATION, A CORPORATION)

8/19/87

DATE

Bill R. Walker, Sr. Vice Pres.

Joe H.S. Mendonca, Asst. Vice Pres.

EASEMENT HOLDER'S CERTIFICATE

PURSUANT TO SECTION 66436 (6) OF THE SUBDIVISION MAP ACT THE SIGNATURES OF THE FOLLOWING EASEMENT HOLDERS OF RECORD ARE OMITTED: WILLIAM R. LEWIS, JR., BY DEED RECORDED OCTOBER 29, 1965 IN VOL. 2085, OFFICIAL RECORDS, AT PG. 341; CHARLES A. MORRIS, SR., ET AL., BY DEEDS RECORDED OCTOBER 29, 1965 IN VOL. 2085, OFFICIAL RECORDS, AT PG. 341; APRIL 21, 1966 AS INST. NO. 14128; AND OCTOBER 12, 1971 AS INST. NO. 39088. PACIFIC TELEPHONE AND TELEGRAPH COMPANY, BY DEEDS RECORDED MARCH 5, 1930 AS INST. NO. 2842; AND SEPTEMBER 3, 1930 AS INST. NO. 10364. WEST STANISLAUS IRRIGATION DISTRICT, BY DEED RECORDED FEBRUARY 19, 1947 AS INST. NO. 4423. SACRAMENTO & SAN JOAQUIN DRAINAGE DISTRICT, BY DEEDS RECORDED OCTOBER 6, 1964 AS INST. NO. 39917; JULY 27, 1967 AS INST. NO. 23644; AND OCTOBER 21, 1971 AS INST. NO. 39088. UNION OIL COMPANY OF CALIFORNIA, BY LEASE RECORDED AUGUST 2, 1983 AS INST. NO. 08357.

NOTARY - CORPORATE

STATE OF CALIFORNIA
COUNTY OF Stanislaus

ON THIS 19th DAY OF August, 1987, IN THE YEAR 1987,

BEFORE ME, THE UNDERSIGNED, A NOTARY PUBLIC IN AND FOR SAID STATE, PERSONALLY APPEARED BILL R. WALKER

AND JOE H.S. MENDONCA PERSONALLY KNOWN

TO ME (OR PROVED TO ME ON THE BASIS OF SATISFACTORY EVIDENCE) TO BE THE PERSONS WHO EXECUTED THE WITHIN INSTRUMENT AS SENIOR VICE

PRESIDENT AND ASSISTANT VICE PRESIDENT

RESPECTIVELY, OF THE CORPORATION THEREIN NAMED, AND ACKNOWLEDGED TO ME THAT THE CORPORATION EXECUTED IT PURSUANT TO ITS BY-LAWS OR A RESOLUTION OF ITS BOARD OF DIRECTORS.

James L. Hilton
NOTARY PUBLIC IN AND FOR SAID COUNTY & STATE

MY COMMISSION EXPIRES: APRIL 1, 1991

NOTE:

MANY PROCEDURES NORMAL AND NECESSARY TO THE OPERATION OF AGRICULTURAL USES SUCH AS FIELD CROPS, VINEYARDS, ORCHARDS, DAIRY AND POULTRY FARMS AND FEED LOTS RESULT IN NOISE, ODOR, DUST, SPRAYING, IRRIGATION OR OTHER POTENTIALLY DETRIMENTAL EFFECTS TO RESIDENTIAL USE OF ADJACENT PROPERTIES. ALL PERSONS PURCHASING LOTS WITHIN THE CONFINES OF THIS APPROVED MAP FOR THE PURPOSE OF ESTABLISHING RESIDENCE SHOULD INVESTIGATE THE LIKELIHOOD OF SUCH CONFLICTS.

CLERK/MANAGER OF THE BOARD OF SUPERVISORS CERTIFICATE

THIS IS TO CERTIFY THAT THE OWNERS OF THE PROPERTY SHOWN ON THE ACCOMPANYING MAP HAVE FILED WITH THE CLERK/MANAGER OF THE BOARD OF SUPERVISORS: (CHECK ONE)

- ☒ A. A BOND OR DEPOSIT APPROVED BY SAID BOARD TO SECURE THE PAYMENT OF TAXES AND SPECIAL ASSESSMENTS COLLECTED AS TAXES, WHICH ARE AT THE TIME OF FILING THIS MAP, A LIEN AGAINST SAID PROPERTY OR ANY PART THEREOF.
- ☐ B. RECEIPTED TAX BILL OR BILLS OR SUCH OTHER EVIDENCE AS MAY BE REQUIRED BY SAID BOARD SHOWING FULL PAYMENT OF ALL APPLICABLE TAXES.

DATED THIS 28th DAY OF August, 1987.

CLAUDIA LEONG, CLERK/MANAGER OF THE BOARD OF SUPERVISORS

BY: Patricia A. Minton, DEPUTY

TAX COLLECTOR'S CERTIFICATE

THIS IS TO CERTIFY THAT THERE ARE NO LIENS FOR ANY UNPAID STATE, COUNTY, SCHOOL, MUNICIPAL, OR IRRIGATION TAXES, OR SPECIAL ASSESSMENTS, EXCEPT SPECIFIC ASSESSMENTS OR TAXES NOT YET PAYABLE AGAINST THE LAND SHOWN ON THIS MAP.

AS TO STATE, COUNTY, SCHOOL OR MUNICIPAL TAXES:

DATED THIS 28 DAY OF August, 1987.

DON FAIRCHILD, COUNTY TAX COLLECTOR
016-0926-813

BY: Mary E. Gurnee, DEPUTY

AS TO IRRIGATION TAXES:

DATED THIS 31 DAY OF August, 1987.

BY: Shane P. Donlon, Director
TAX COLLECTOR, EL SOLYO WATER DISTRICT

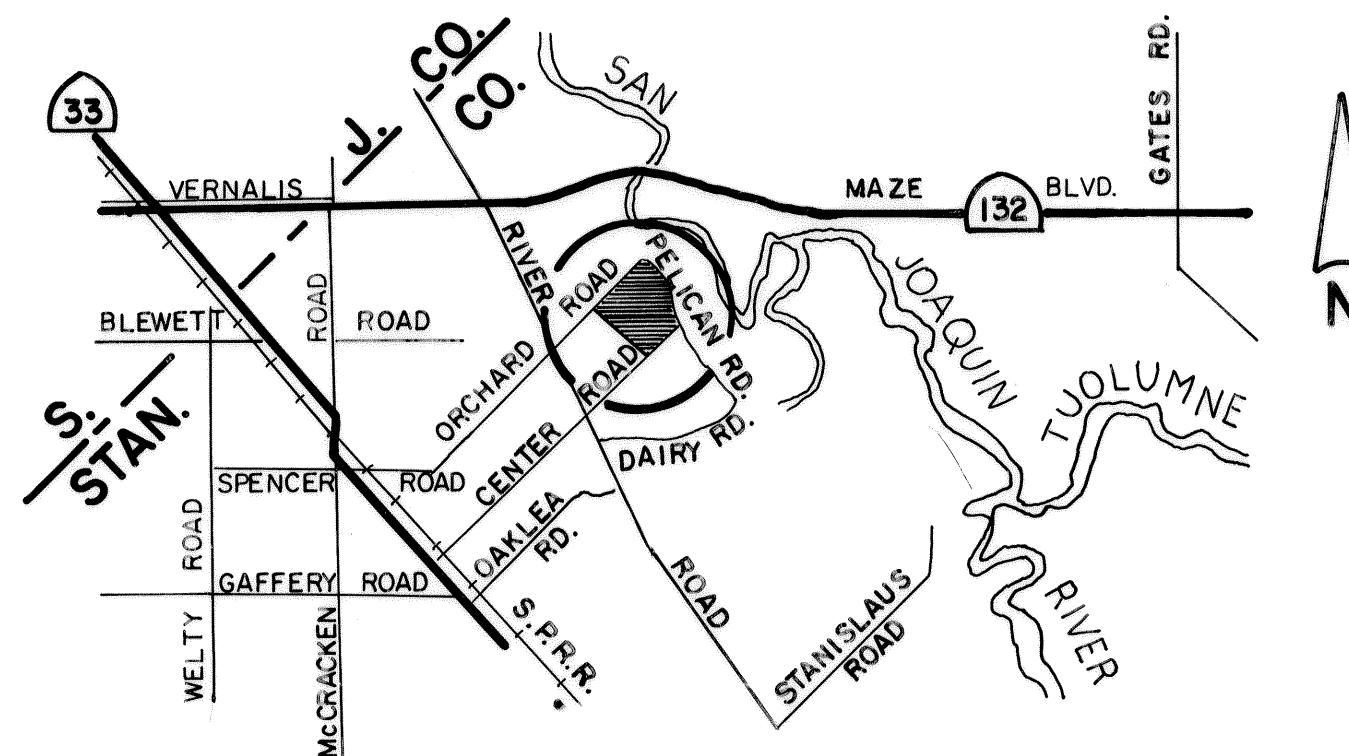
VICINITY MAP**RECORDER'S CERTIFICATE**

FILED THIS 8 DAY OF Sept, 1987, AT 2:10 P.M.,

IN BOOK 39 OF PARCEL MAPS AT PAGE 96 AT THE REQUEST OF

Central Valley Prod. Credit

INST. NO. 114021

DAVID A. WURM

COUNTY RECORDER

FEES \$ 8.00

Pat Seidel
CHIEF DEPUTY RECORDER

SURVEYOR'S CERTIFICATE

THIS MAP WAS PREPARED BY ME OR UNDER MY DIRECTION AND IS BASED UPON A FIELD SURVEY IN CONFORMANCE WITH THE REQUIREMENTS OF THE SUBDIVISION MAP ACT AND LOCAL ORDINANCE AT THE REQUEST OF CENTRAL VALLEY PROD. CREDIT ASSOC.

Production Credit Assoc. ON August 4, 1987.

I HEREBY STATE THAT THIS PARCEL MAP SUBSTANTIALLY CONFORMS TO THE APPROVED OR CONDITIONALLY APPROVED TENTATIVE MAP, AND ALL MONUMENTS ARE OF THE CHARACTER AND OCCUPY THE POSITIONS INDICATED. THE MONUMENTS ARE SUFFICIENT TO ENABLE THE SURVEY TO BE RETRACED.

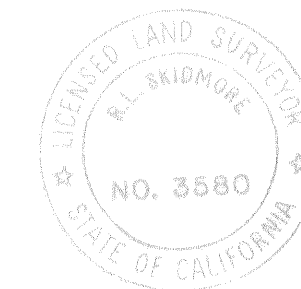

Richard L. Skidmore
RICHARD L. SKIDMORE L.S. 3580
(EXPIRES 6/30/88)

COUNTY SURVEYOR'S CERTIFICATE

THIS MAP CONFORMS WITH THE REQUIREMENTS OF THE SUBDIVISION MAP ACT AND LOCAL ORDINANCES.

H. R. CALLAHAN

COUNTY SURVEYOR

DATED THIS 2nd DAY OF September, 1987.

BY: J. Ray Edwards
DEPUTY R.C.E. 18573

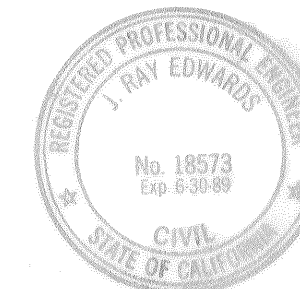
**PARCEL MAP**

BEING A DIVISION OF PARCEL B AS SHOWN IN BOOK 37 OF PARCEL MAPS AT PAGE 77, AND LYING WITHIN SECTION 32, TOWNSHIP 3 SOUTH, RANGE 7 EAST, AND SECTION 5, TOWNSHIP 4 SOUTH, RANGE 7 EAST, MOUNT DIABLO MERIDIAN, STANISLAUS COUNTY

R.B. WELTY & ASSOCIATES, INC.
P.O. BOX 1724
521 13TH STREET
MODESTO, CALIFORNIA 95353-1724
(209) 526-1515 SHEET 1 OF 2

STANISLAUS COUNTY FILE NO. 87-46 AG
JOB NO. 56168

RECORDER'S CERTIFICATE

FILED THIS 8 DAY OF Sept, 1987, AT 2:10 P.M.,
IN BOOK 39 OF PARCEL MAPS AT PAGE 96 AT THE REQUEST OF
Central Valley Prod. Credit
INST. NO. 114021
FEES \$ 8.00

DAVID A. WURM
COUNTY RECORDER
Rat Seidel
CHIEF DEPUTY RECORDER

BASIS OF BEARINGS:

A COURSE OF NORTH 45°28'26" EAST AS SHOWN FOR THE CENTERLINE OF ORCHARD ROAD, ALSO A PORTION OF THE NORTHWESTERLY LINE OF PARCEL B IN BOOK 37 OF PARCEL MAPS AT PAGE 77, STANISLAUS COUNTY RECORDS.

LEGEND:

○ INDICATES SET 3/4" x 30" LONG IRON PIPE W/TAG L.S.3580
● " FOUND 3/4" IRON PIPE W/TAG L.S.3580 AS PER (R)
(M) " MEASURED THIS SURVEY
(*) " BEARING, DISTANCE OR ANGLE, CALCULATED FROM
(R) " RECORD DATA, AS NOTED
BOOK 37 OF PARCEL MAPS AT PAGE 77

PARCEL MAP

BEING A DIVISION OF PARCEL B AS SHOWN IN BOOK 37 OF PARCEL MAPS AT PAGE 77, AND LYING WITHIN SECTION 32, TOWNSHIP 3 SOUTH, RANGE 7 EAST, AND SECTION 5, TOWNSHIP 4 SOUTH, RANGE 7 EAST, MOUNT DIABLO MERIDIAN, STANISLAUS COUNTY

R.B. WELTY & ASSOCIATES, INC.
P.O. BOX 1724
521 13TH STREET
MODESTO, CALIFORNIA 95353-1724
(209) 526-1515 SHEET 2 OF 2

STANISLAUS COUNTY FILE NO. 87-46 AG
JOB NO. 56168

