

BERKELEY

BLOCKS 17-18-19
THOUSAND OAKS
26 M 8

ALAMEDA COUNTY

FIELD NOTE TABLE

INSTRUMENT AT B1279 BACKSITE B1231

BS=270°00'00" DISTANCE=132.04'

FORESITE	ANGLE	DISTANCE
RP-1	299°55'25"	34.51'
RP-2	55°47'32"	30.64'
RP-3	120°01'19"	33.85'
RP-4	235°26'21"	31.03'

B1231 FOUND 1-1/2" BRASS DISK WITH
PUNCH STAMPED "CITY OF BERKELEY
UNLAWFUL TO DEFACE" (DOWN 0.6')

SAN JUAN AVENUE

132.10' MONUMENT TO INTERSECTION OF REFERENCE CROSS

THOUSAND OAKS
25 M 2

LEGEND

- FOUND POSITION OF B1279, 1/4" BRASS PIN MONUMENT, 0.9' BELOW SURFACE IN MONUMENT WELL
- ⊙ FOUND MONUMENT AS NOTED (B1231)
- ▲ RECORD POSITION OF B1279 PER CR 4695
- + FOUND REFERENCE CROSS PER CR 4695, BOOK 42, PG 35
- () RECORD DISTANCE PER CR 4695
- [] ELEVATION (375.12') MEASURED FROM REFERENCED MONUMENT B1279 USING A LEICA DNA10 DIGITAL LEVEL

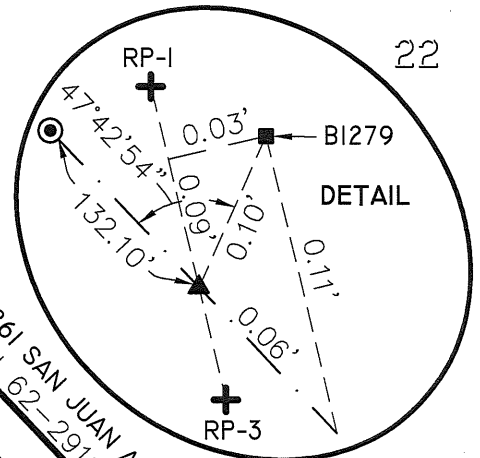

BLOCK 4

NO SCALE



ADDRESS: 1861 SAN JUAN AVENUE
APN: 62-2911-27

CR# 6085

CR